

INSTRUCTIONS

Pages 4-7 contain images of various materials
(in colour or black and white).

Cut out the materials place them onto the correct sheet,
are they rubbish or recycling?

You will find answers on page 8.

RECYCLING

Can be recycled at home

RUBBISH

Can't be recycled at home



PLASTIC BOTTLES



DRINK CANS



FRUIT



PIZZA BOXES

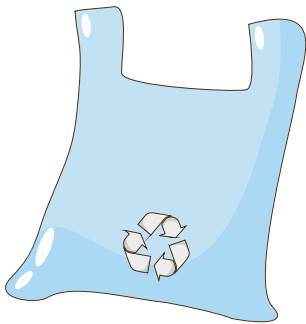

PLASTIC BAGS

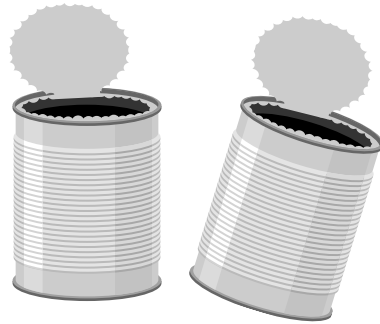

FOOD TINS



PLASTIC MILK BOTTLES



SWEET WRAPPERS



VEGETABLES



COFFEE CUPS

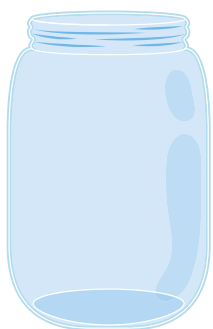

GLASS JARS



NAPPIES



OLD PHONES

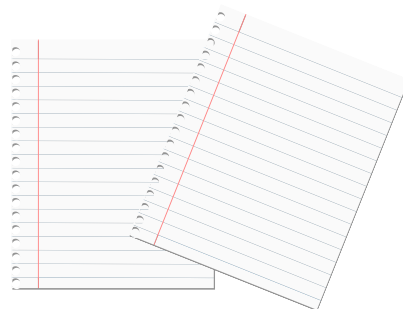

PAPER



CARDBOARD



OLD LAPTOPS

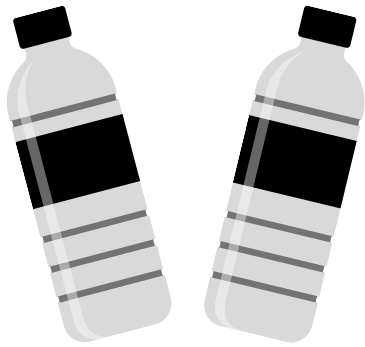

PLASTIC BOTTLES



DRINK CANS



FRUIT

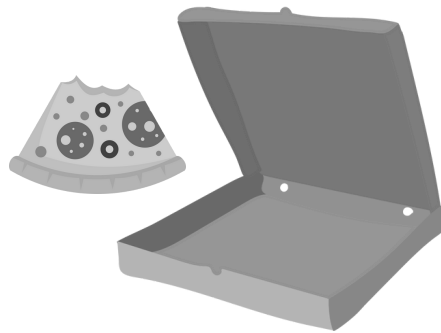

PIZZA BOXES

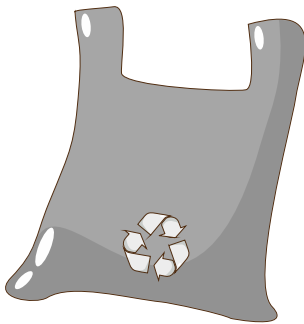

PLASTIC BAGS

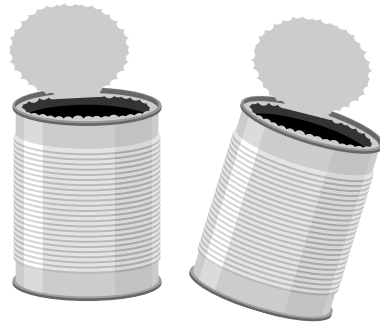

FOOD TINS



PLASTIC MILK BOTTLES

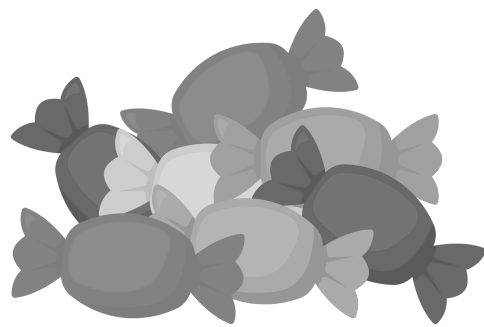

SWEET WRAPPERS

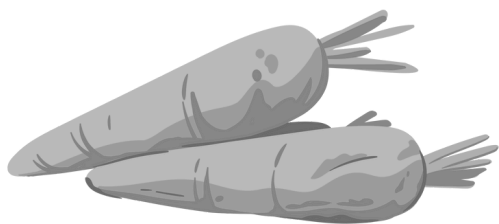

VEGETABLES

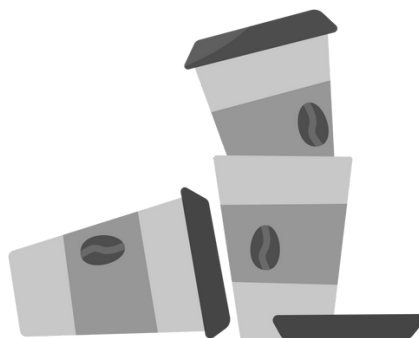

COFFEE CUPS



GLASS JARS



NAPPIES



OLD PHONES

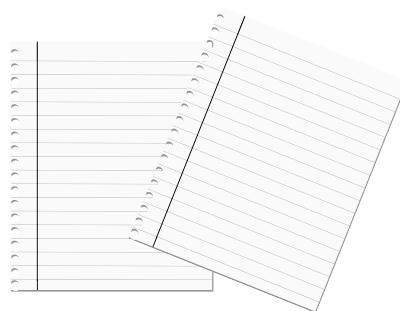

PAPER



CARDBOARD



OLD LAPTOPS

ANSWERS**CAN****BE RECYCLED AT HOME**

- Plastic bottles
- Drinks cans
- Food tins
- Plastic milk bottles
- Glass jars
- Paper
- Cardboard

CANNOT**BE RECYCLED AT HOME**

- Fruit & vegetables - *Can be composted instead*
- Pizza boxes - *Contaminated with grease and food. All materials should be clean and dry.*
- Plastic bags
- Sweet wrappers
- Disposable coffee cups - *Made from mixed materials*
- Nappies
- Electricals